

# LF1 Series Adjustable Supports LED Illumination Units

## Adjustable mounting angle 0° to 90° in 10° increments Flexible mounting on machines

- The adjustable supports hold the LED illumination unit at a required angle.
- In an application for inspection, the angle of the LED illumination unit can be adjusted for the convenience of the inspector.

### Application Examples

Internal illumination for machine tools, metal processing machines, semiconductor production equipment, printing presses, chip mounters, and automatic production machines; illumination for visual inspection, etc.

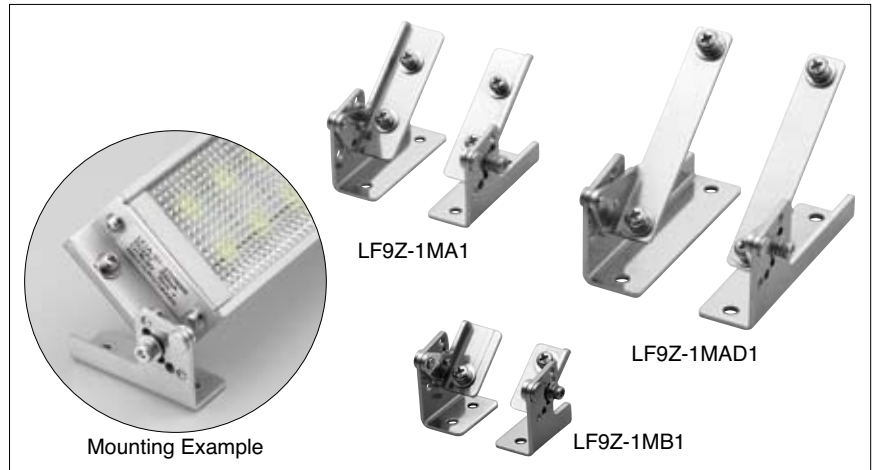

### Types

Name	Ordering Type No.	Applicable LED Illumination Unit	Package Quantity	Material
Adjustable Support for LF1 Series	LF9Z-1MB1	LF1B-A, -B, and -C (-D not applicable)	1 pair (right and left)	Stainless steel
	LF9Z-1MA1	LF1A-A, -B, and -D		
	LF9Z-1MAD1	LF1A-D2F		

### Dimensions

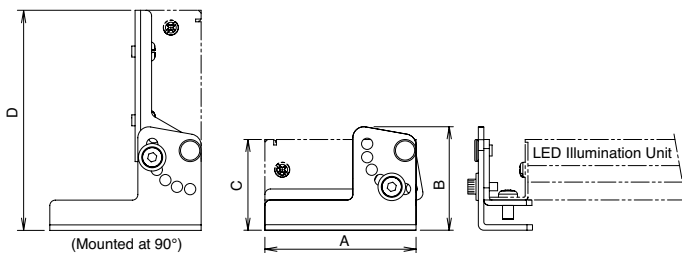

The above figure illustrates the LF9Z-1MA1.

#### • Dimensions (mm)

Type No.	A	B	C	D
LF9Z-1MB1	27.5	35.2	27	50.5
LF9Z-1MA1	55	37.9	33	80
LF9Z-1MAD1	88	43.2	37	121

The angle is adjusted using hex socket bolts.  
Applicable environment and mechanical strength depend on the LED illumination unit.

### Mounting Hole Layout

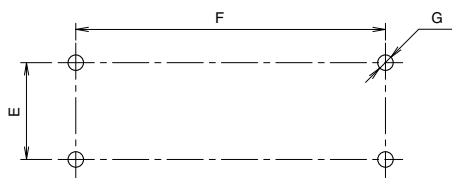

#### • Dimensions (mm)

Type No.	E	F	G
LF9Z-1MB1	14	(Note)	4-ø4.2
LF9Z-1MA1	25	(Note)	4-ø4.2
LF9Z-1MAD1	74	231	4-ø5.5

Note: Same as the LED illumination unit.

Specifications and other descriptions in this leaflet are subject to change without notice.



## IDEC CORPORATION

**IDEC CORPORATION (USA)**  
Tel: +1-408-747-0550 / (800) 262-IDEC (4332)  
Fax: +1-408-744-9055 / (800) 635-6246  
E-mail: opencontact@idec.com

**IDEC CANADA LIMITED**  
Tel: +1-905-890-8561, Toll Free: (888) 317-4332  
Fax: +1-905-890-8562  
E-mail: sales@ca.idec.com

**IDEC AUSTRALIA PTY. LTD.**  
Tel: +61-3-9763-3244, Toll Free: 1800-68-4332  
Fax: +61-3-9763-3255  
E-mail: sales@au.idec.com

7-31, Nishi-Miyahara 1-Chome, Yodogawa-ku, Osaka 532-8550, Japan  
Tel: +81-6-6398-2571, Fax: +81-6-6392-9731  
E-mail: products@idec.co.jp

**IDEC ELECTRONICS LIMITED**  
Tel: +44-1256-321000, Fax: +44-1256-327755  
E-mail: sales@uk.idec.com

**IDEC ELEKTROTECHNIK GmbH**  
Tel: +49-40-25 30 54 - 0, Fax: +49-40-25 30 54 - 24  
E-mail: service@idec.de

**IDEC (SHANGHAI) CORPORATION**  
Tel: +86-21-5353-1000, Fax: +86-21-5353-1263  
E-mail: idec@cn.idec.com

**IDEC IZUMI (H.K.) CO., LTD.**  
Tel: +852-2803-8989, Fax: +852-2565-0171  
E-mail: info@hk.idec.com

**IDEC TAIWAN CORPORATION**  
Tel: +886-2-2698-3929, Fax: +886-2-2698-3931  
E-mail: service@idec.com.tw

**IDEC IZUMI ASIA PTE. LTD.**  
Tel: +65-6746-1155, Fax: +65-6844-5995  
E-mail: info@sg.idec.com